

CONTENTS

No.	Parts Names	Quantity	
1	Front plate and handle	1	✓
2	Back plate and handle	1	✓
3	Seal of plate	2	✓
4	8x8mm Square spindle + Adjusting spring	1+2	✓
5	M5x90 Hexagon socket head bolt	3	✓
6	Spare code tumbler	2	✓
7	Tweezer for code changing	1	✓
8	Allen key	2	✓
9	Cylinder hole escutcheons + Self-tapping screw	1 pairs + 4	✓
10	60mm Latchbolt + Self-tapping screw + Strike	1+4+1	✓
13	Cylinder support post (Tubular latch)	1	✓

FEATURES

- Model 70261** has no panic function key "F", but the function key "X" for transferring between code function and code-free function. There are a total of 2,047 codes available on the **model 70261**, any of which may be entered in any order.
- Model 70262** has panic function key "F". Press the key "F", it is applicable for panic function, that is, rotating the handle without entering code to open or close the door. Press "F" again and "C", it is not applicable for panic function, that is, the code must be entered to open or close the door. There are a total of 1,023 codes available on the **model 70262**, any of which may be entered in any order.
- Model 70261/2** is for use with tubular latchbolt, which is a big latchbolt with 60mm of central distance provided by us.
- This product is fit for the door of between 35mm and 60mm thick.
- Inside or outside handle is available for left or right hand door.
- There is a clutch in the outside handle against idling if the handle is forced to protect the inner parts of lock. The handle can be recovered by hand.
- It is convenient to change the code upon your need at any time according to the Code Changing Instructions.
- This product is safe and stable with high weather, vandal, decoding, corrosion resistance and general applicability.

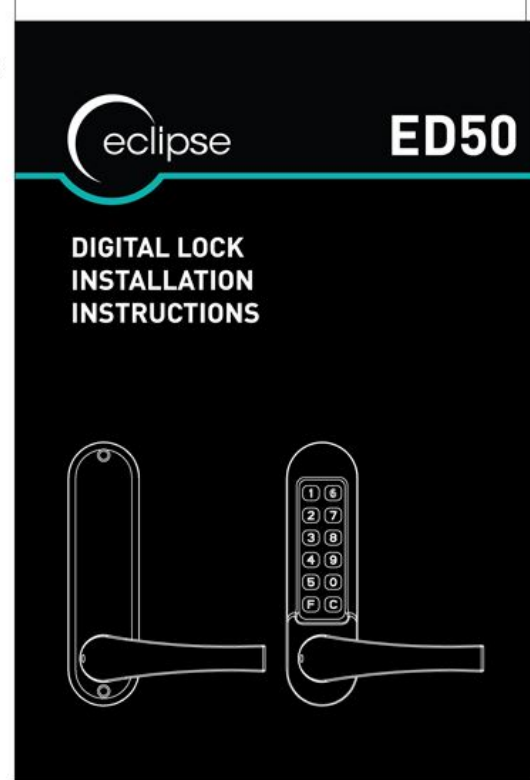
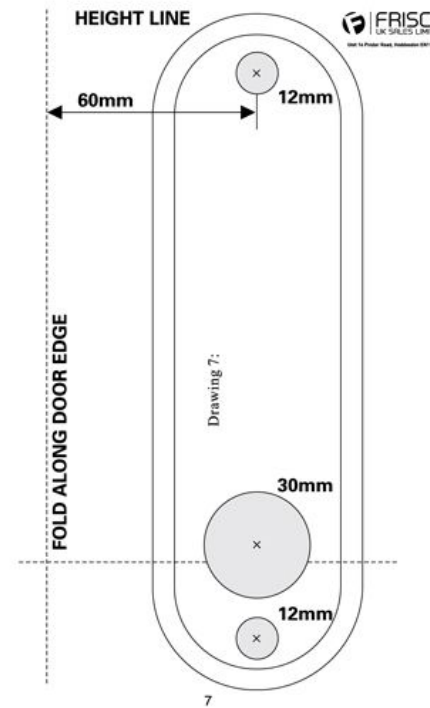
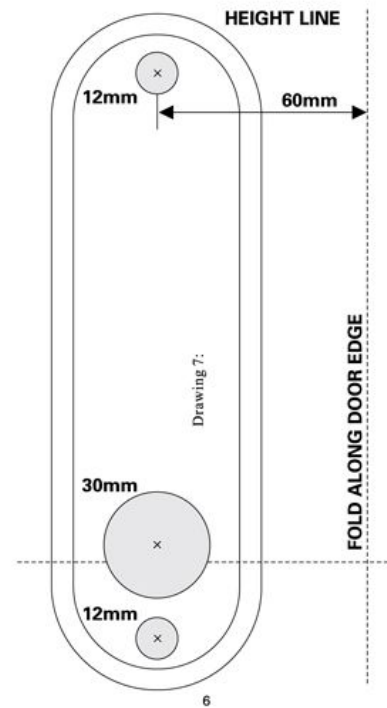

INSTALLATION

- Crease the Drawing 7: Drilling Dimensions Template along the dotted line to be 90°, and tape it to the proper position on the door along the door edge shown as Drawing 8.
- Keep the drill level and square to the door, drill and chisel the hole according to the template shown as Drawing 7. Note: Leave enough space for the cam of latchbolt to rotate.
- Put the latchbolt (Part No. 10) into the hole and fix it with two self-tapping screws to allow the faceplate of latchbolt to fully fit flush to the surface of door edge without protruding part shown as Drawing 9. Fix the strike on the corresponding door case and chisel out the aperture of the strike to receive the latchbolt.
- Fix latch support post (Part No. 13) into the back of front plate (Part No. 1) according to the hand of your door, shown as Drawing 10, A for a right hand door, or B for a left hand door.
- Separately insert tower like adjusting springs of spindle into the hole of front and back plates. The bigger part of the spring shall be faced inside.
- Pass the spindle (Part No. 4) through central rectangular hole of tubular latch to protrude out of the door at both sides. Then apply the front and back plates, with the seals in position, closely against the door, over the protruding ends of the spindle.

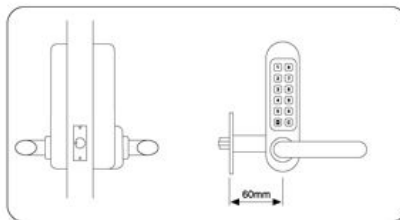

Drawing 4: Installation of Model

- Fix the two plates together using the black socket head bolt, starting with the top fixing. Ensure that the two plates are truly vertical after several code entering and unlocking tests, and then tighten the bolts using the "T" shaped Allen key.

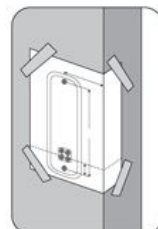

Drawing 8: Taping Schematic Diagram

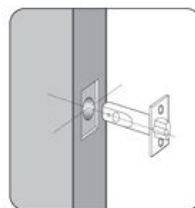

Drawing 9: Latchbolt Drilling and Installing Schematic Diagram

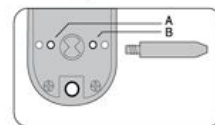

Drawing 10: Latch Support Post Installation Diagram for Left or Right Hand Door

NOTES

- Drill from both sides for greater accuracy and to avoid splintering out of the door face.
- If check the lock after it is well installed, please note: (1). Don't stand out of the door when check to close the door to avoid accidental lock-ins from forgetting the code; (2). If it is necessary, the code card shall be taken.
- If drill or chisel holes by yourself, all the necessary tools, careful operation, reading of instructions or familiar workers shall be needed.
- All door locks shall be installed with a degree of precision to ensure that all components are horizontally and vertically accurate in relation to each other, and in relation to the door.

CHANGING THE CODE

- Take your PushButton lock off the door by unscrewing the 2 bolts in the backplate.
- Press the C button to reset the chamber and place the lock case on a flat surface with the buttons down.
- Remove the 4 red screws and carefully lift off the code chamber plate. Check that all 12 springs are held in place on the plate.
- Note that the red tipped code tumblers correspond in position to the existing code. The blue tipped non-code tumblers fill the other positions. The C tumbler is not coloured.
- Hold the lock in your hand and depress the C button. Keeping the C button depressed use tweezers to re-position the tumblers to correspond with your new code. The square notches of ALL tumblers MUST face outwards, with the coloured tips ON TOP. See diagram below. DO NOT force the tumblers in.

NB-Holding the C button depressed whilst removing or replacing the tumblers is ESSENTIAL to avoid damaging the internal mechanism. DO NOT attempt to reposition the C tumbler.



- Replace the code chamber plate carefully with the 4 red screws.
- Check the operation of the new code, and make a written note of it before re-installing the lock.

ASSEMBLY PARTS DRAWING

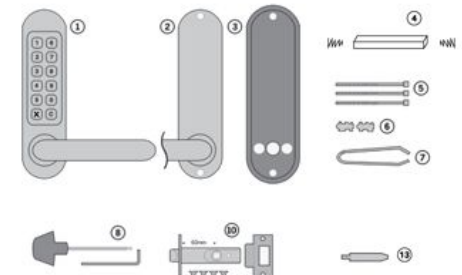

PASSAGE FREE KEY DIFFERENCE

